

Tottenham Pavilion - Behind the Façades (in different views)

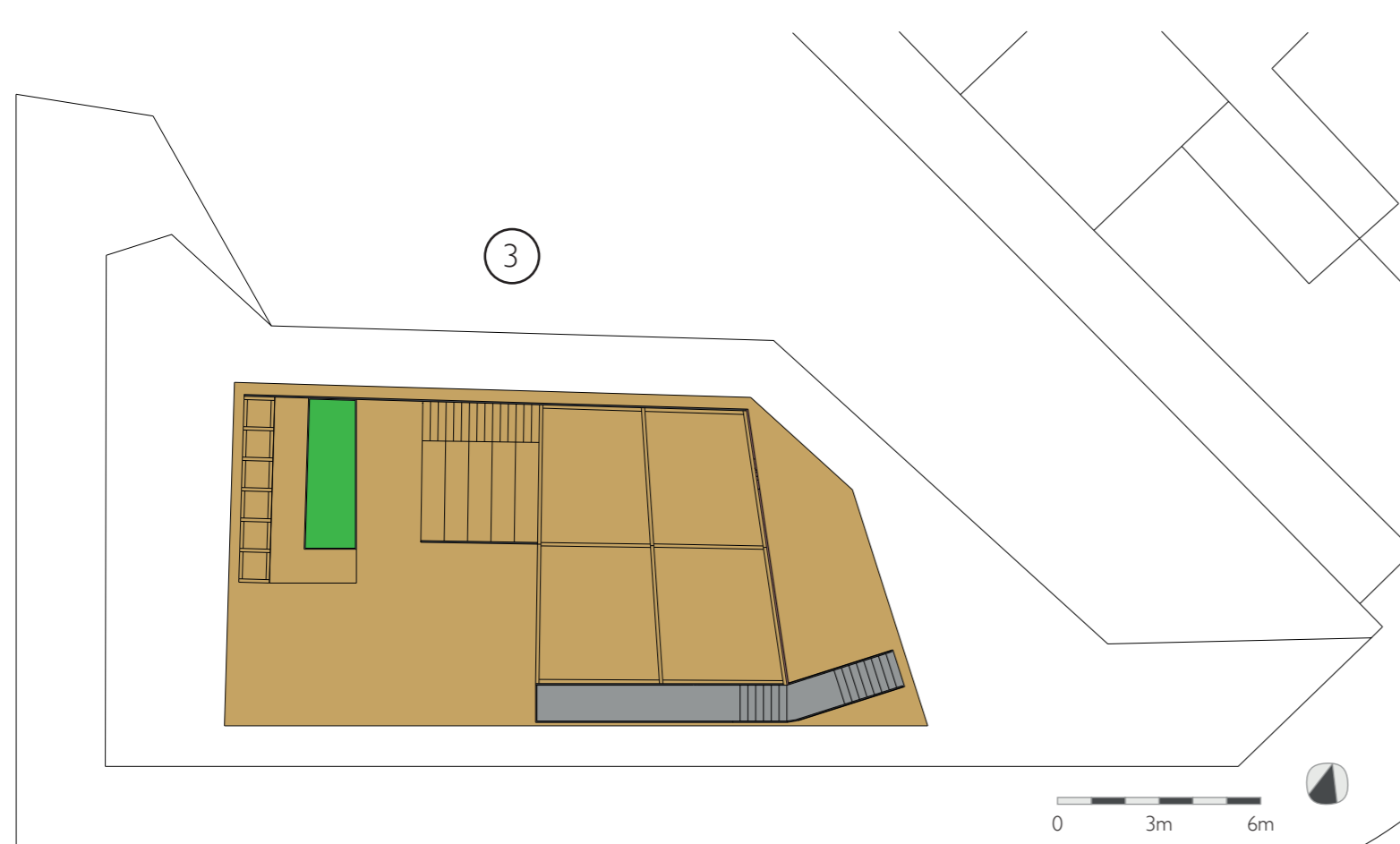
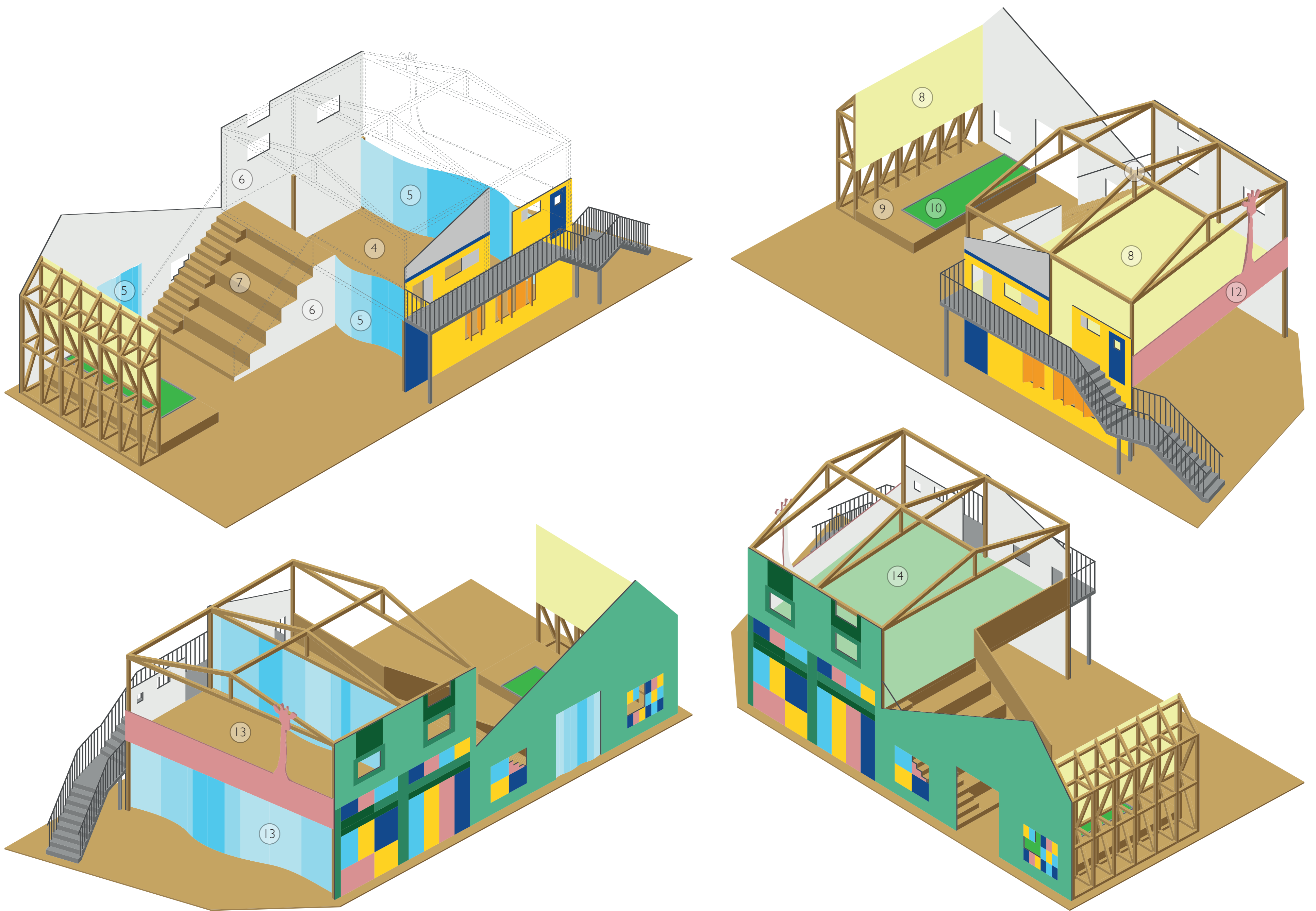

- ① Basic concept (connecting and reinterpreting 3 different façades)
- ② Some of Harringay Warehouse District's façades
- ③ 1:200 Site Plan
- ④ Two-storey space of interchangeable public or private functions
- ⑤ Movable partitions (curtains) to create open or enclosed spaces
- ⑥ Blank murals to be filled by the local community
- ⑦ Staircase/ seating with storage/ WC underneath
- ⑧ Possible exhibition areas/ film screening
- ⑨ Stage/ seating
- ⑩ Community garden
- ⑪ Open pitched roof structure
- ⑫ Giraffe-shaped timber balustrade (a nod to one of the resident's hanging giraffe sculpture)
- ⑬ Possible two-storey market/ workshop/ meeting areas
- ⑭ Possible green space