

METAMORPHOSIS

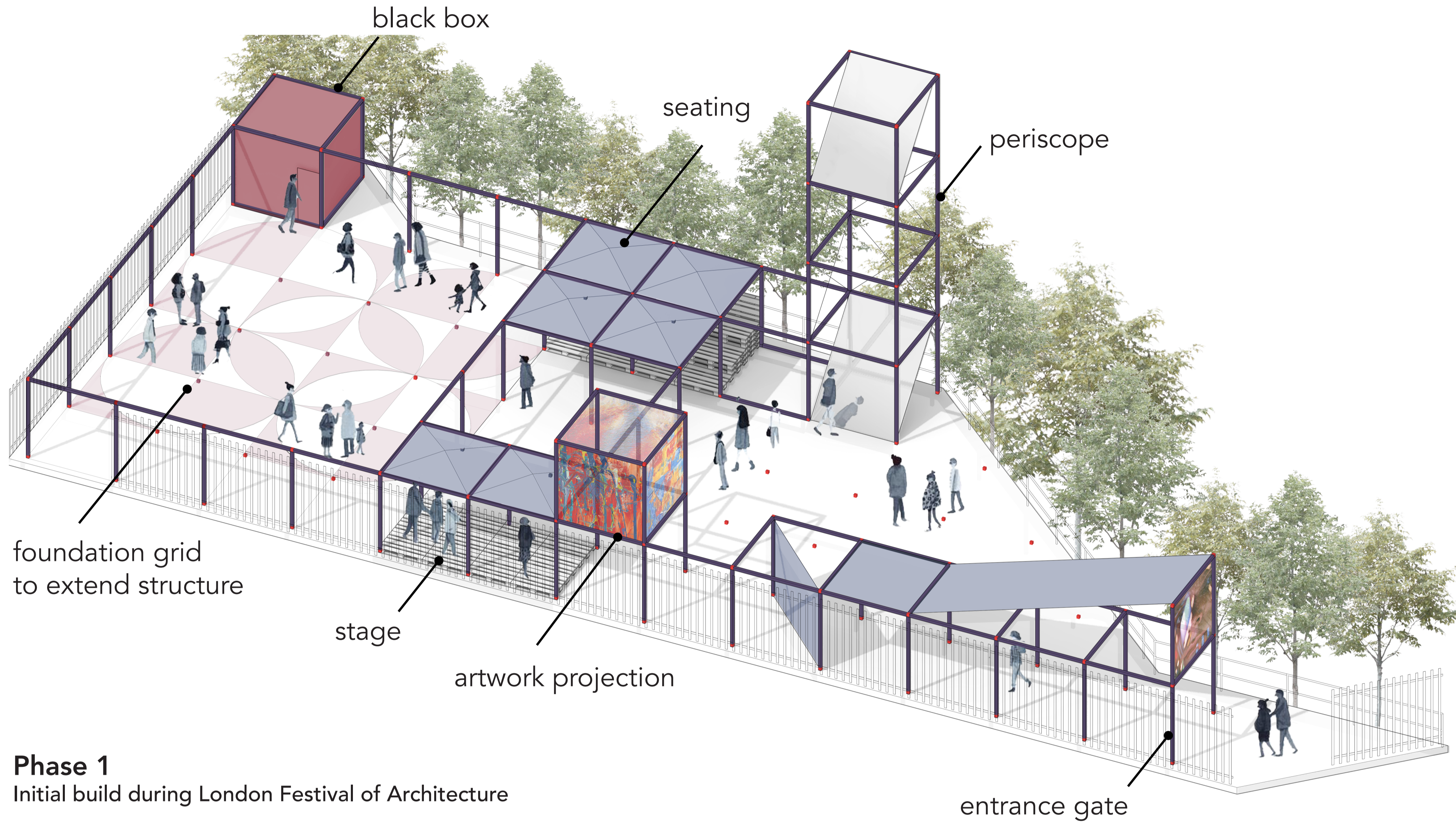

Phase 1
Initial build during London Festival of Architecture

OFF-THE-SHELF MATERIALS:

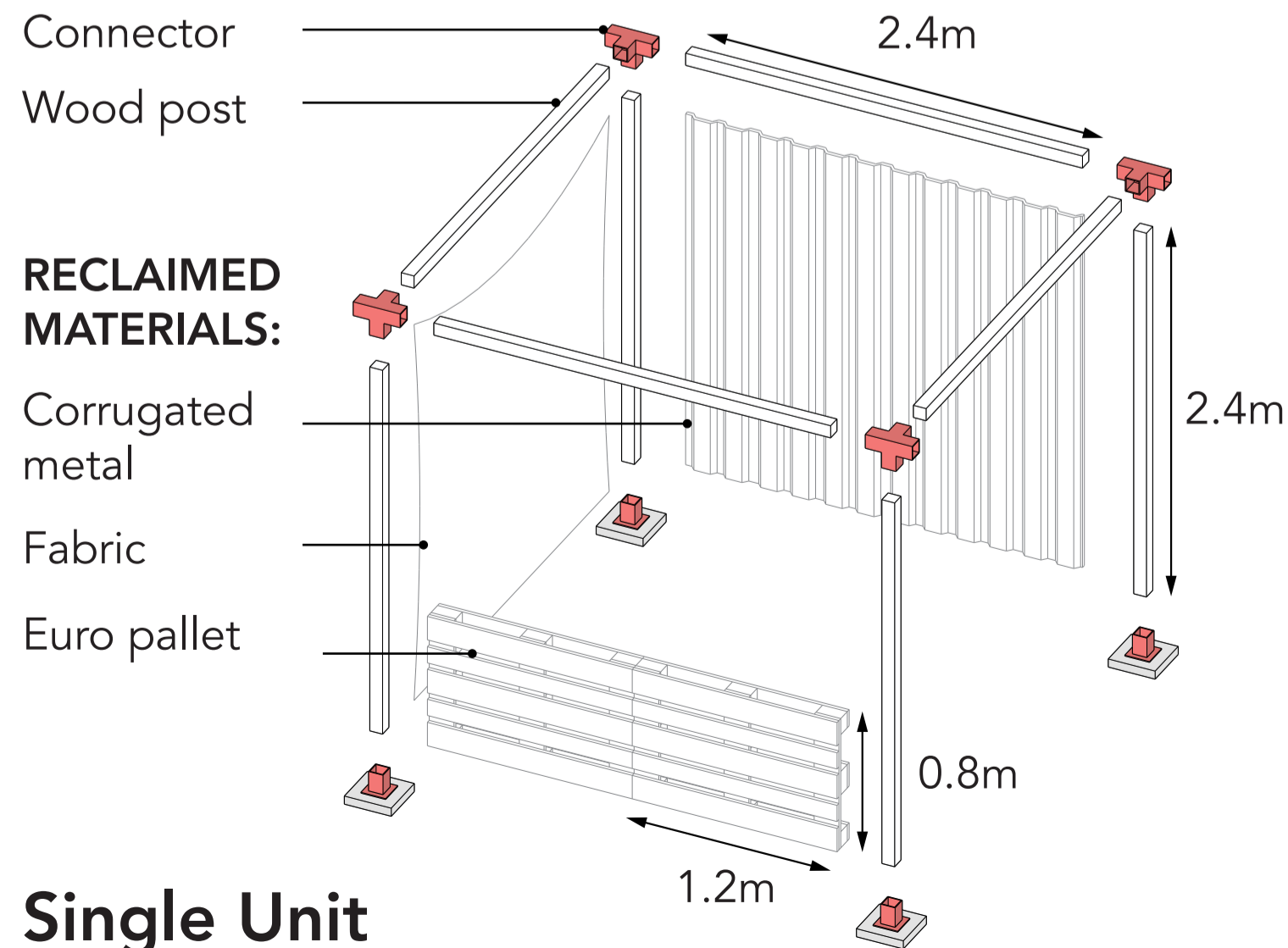

Single Unit

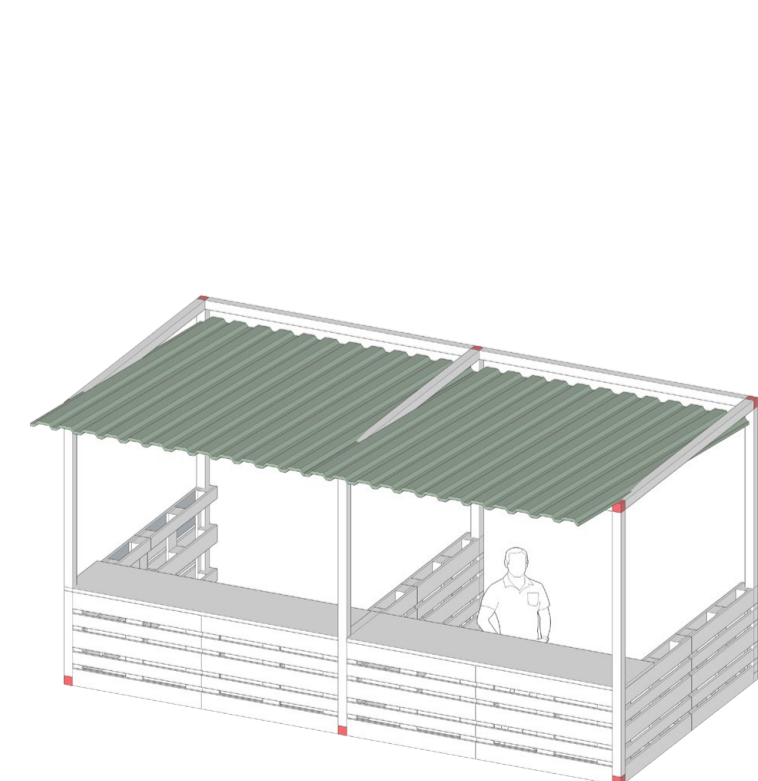

Market stall

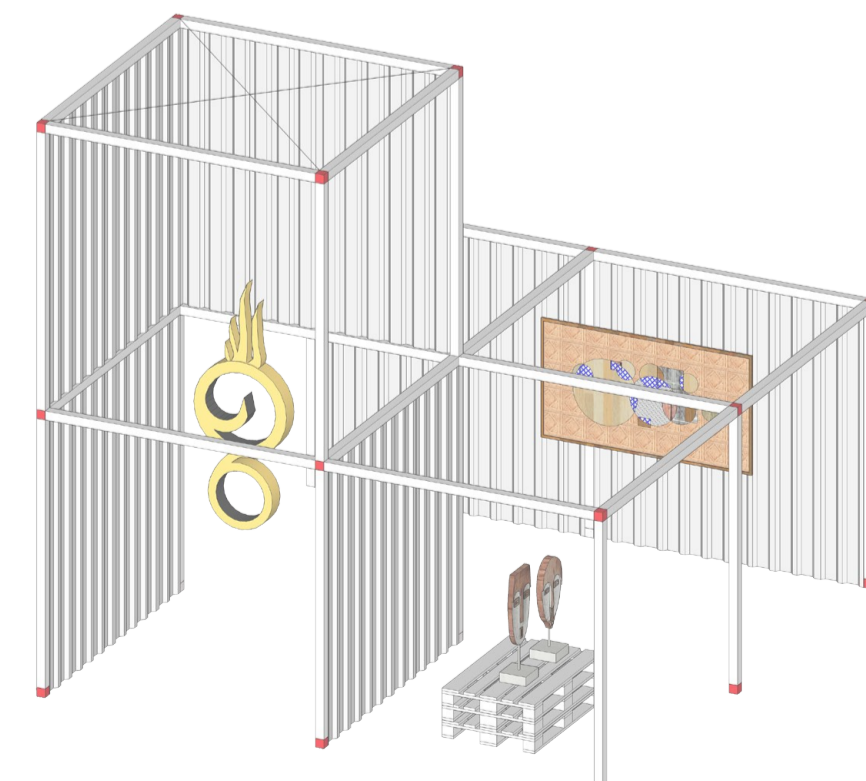

Gallery

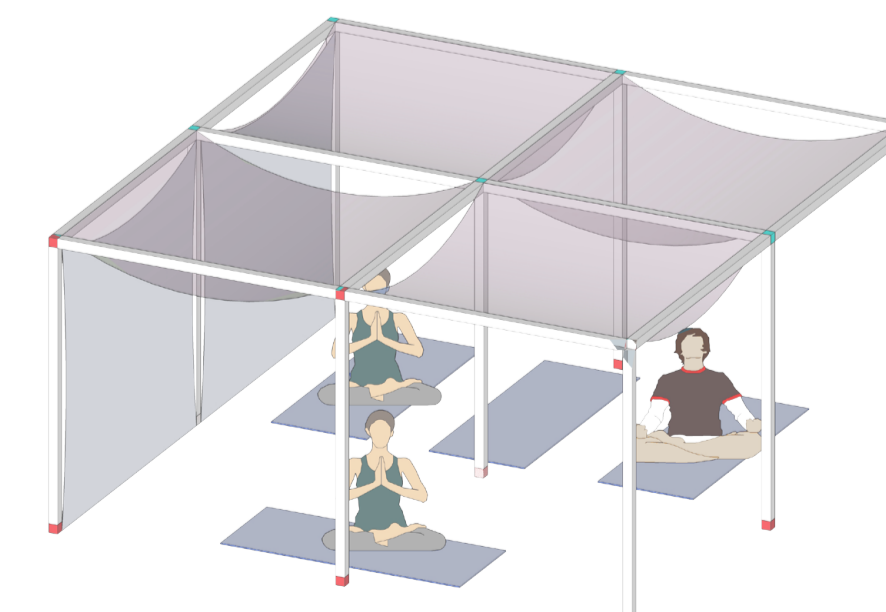

Workshop ...

The structure can easily be modified and transformed to accommodate new functions.

Concept

The pavilion draws its inspiration from the Warehouse Community, where the structure of the warehouses served the residents as a framework in which they build their homes according to their own ideas.

The heart of the pavilion is the flexible space in the centre. It can be transformed easily by the residents for different uses such as markets, exhibitions, performances thanks to the modular structure. The structure can be modified, extended or dismantled & reused. Besides the flexible space, there are fixed elements: The Periscope, The Black Box and the Art Box. They mark fix points and serve as attractions for the visitors during the London Festival of Architecture.

It is imagined that after some time most of the initial elements get transformed into new uses, and the pavilion morphs into a completely new shape, representing the imagination of the community rather than a single person.

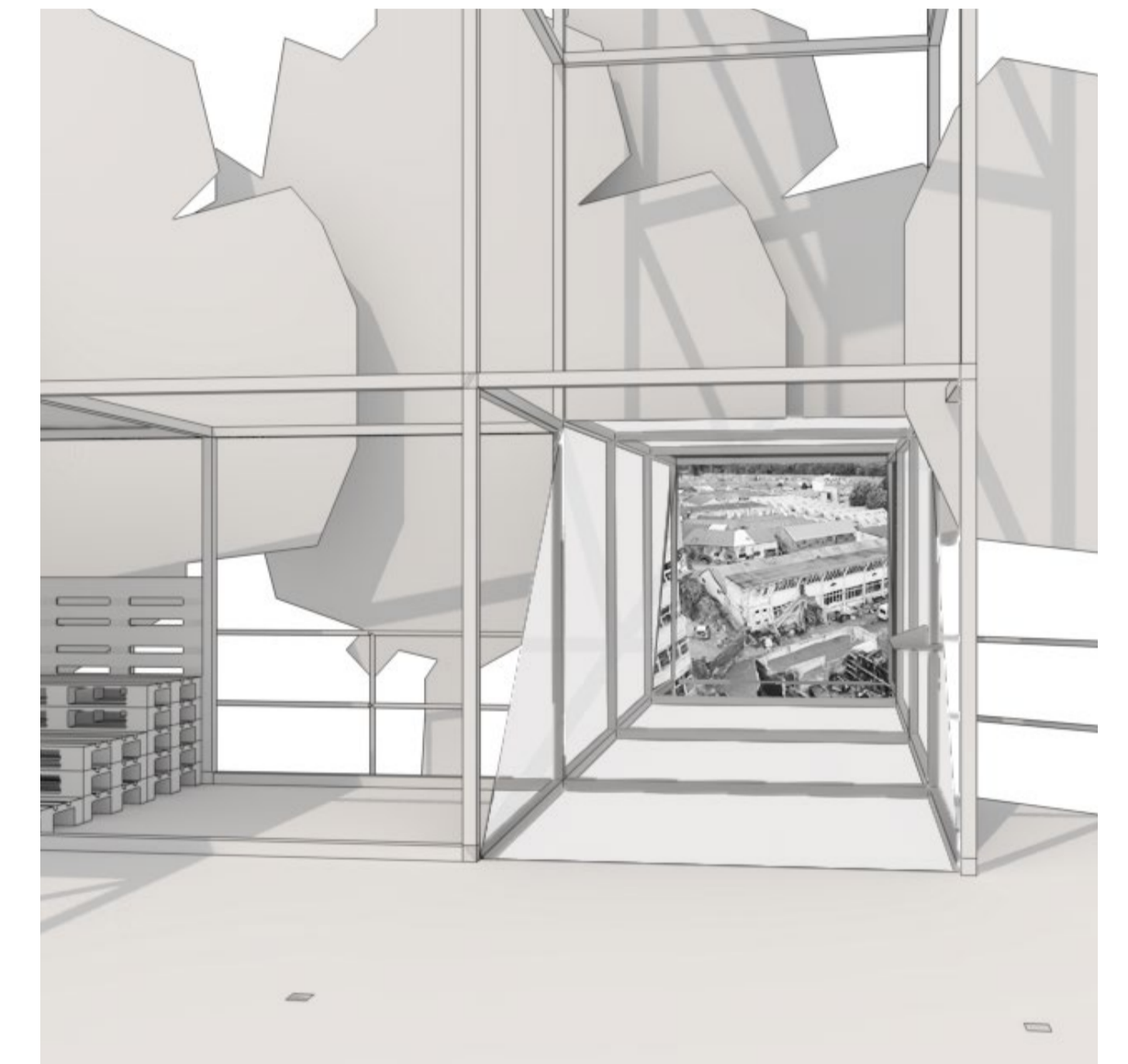

Periscope overlooking warehouse district



The Black box creates an interior space eight times larger than its physical boundaries.