

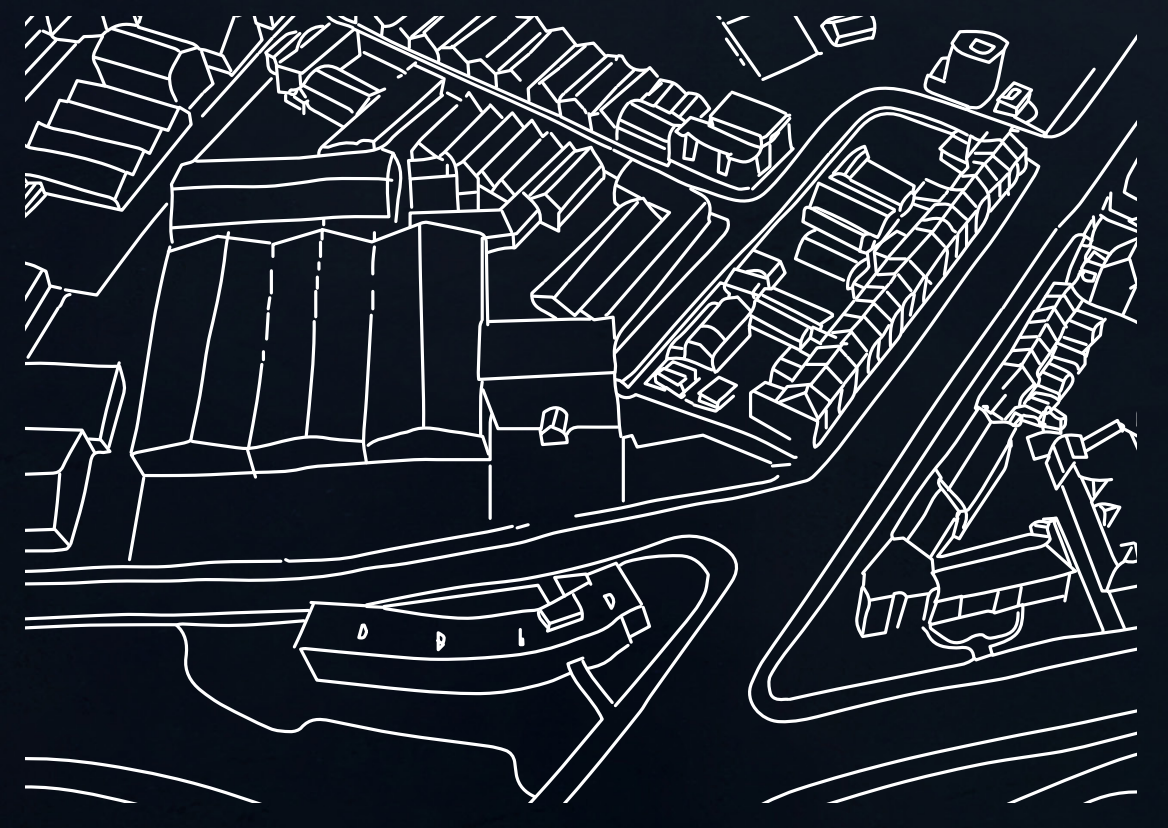

Harringay Warehouse District is a place of creativity, creation, and freedom. The Lantern Pavilion creates a welcoming entrance to the Harringay Warehouse community. The modular zig-zag shaped structure is inspired by the district's skyline. The openness of the "Lantern" is a translation of the community's identity, always ready to welcome new visitors. The high spaces, the dynamic wooden facade, and the floating curtains bring dynamism to the spaces and merge with the surroundings. "The Lantern" lights up the Harringay Warehouse community and becomes a local symbol of hope and closeness, where different people can get inspired together.

THE LANTERN



URBAN MORFOLOGY - LINEAR, REPETITIVE - ZIG-ZAG PATTERN

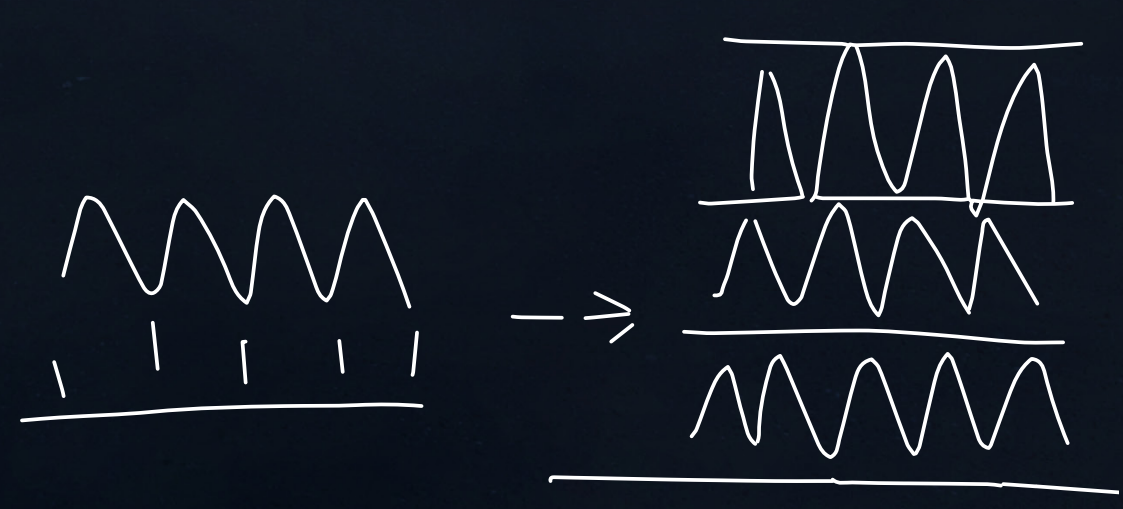

ABSTRACTION - STACKING HARRINGAY WAREHOUSE DISTRICT'S SKYLINE



TOTTENHAM PAVILLION IN SITU - MID-RISE - DISTRICT ENTRANCE

