

The Retractable Pavilion

The main idea of the project is to provide a space for the community to share and perform together different activities. Having that in mind a dynamic architecture was created, whose format changes to better adapt to the use. The retractable format of the Pavilion allows its space to be changed freely according to the use and needs of the community. The pavilion creates three different configurations: totally closed, that can be used for exhibitions or parties; half open, that can be used for street cinemas; and totally open, that works for sport classes, markets and others activities to do in an outdoor scenario on a summer day in Harringay Warehouse District. For its structure the wood was chosen because it is a renewable and sustainable material and can be assemble in the project area without a waste of material. For the walls a white fabric works as a kind of a white canvas that changes according to the light or image that is projected on it, as a reference to the paintings and graffiti that are made in Harringay Warehouse District. This enables the desire of the community to create with freedom the space in the way they want it to be, and look how they want it to be. The idea is that the local residents and artists appropriate and modify the pavilion according to their needs and identity.

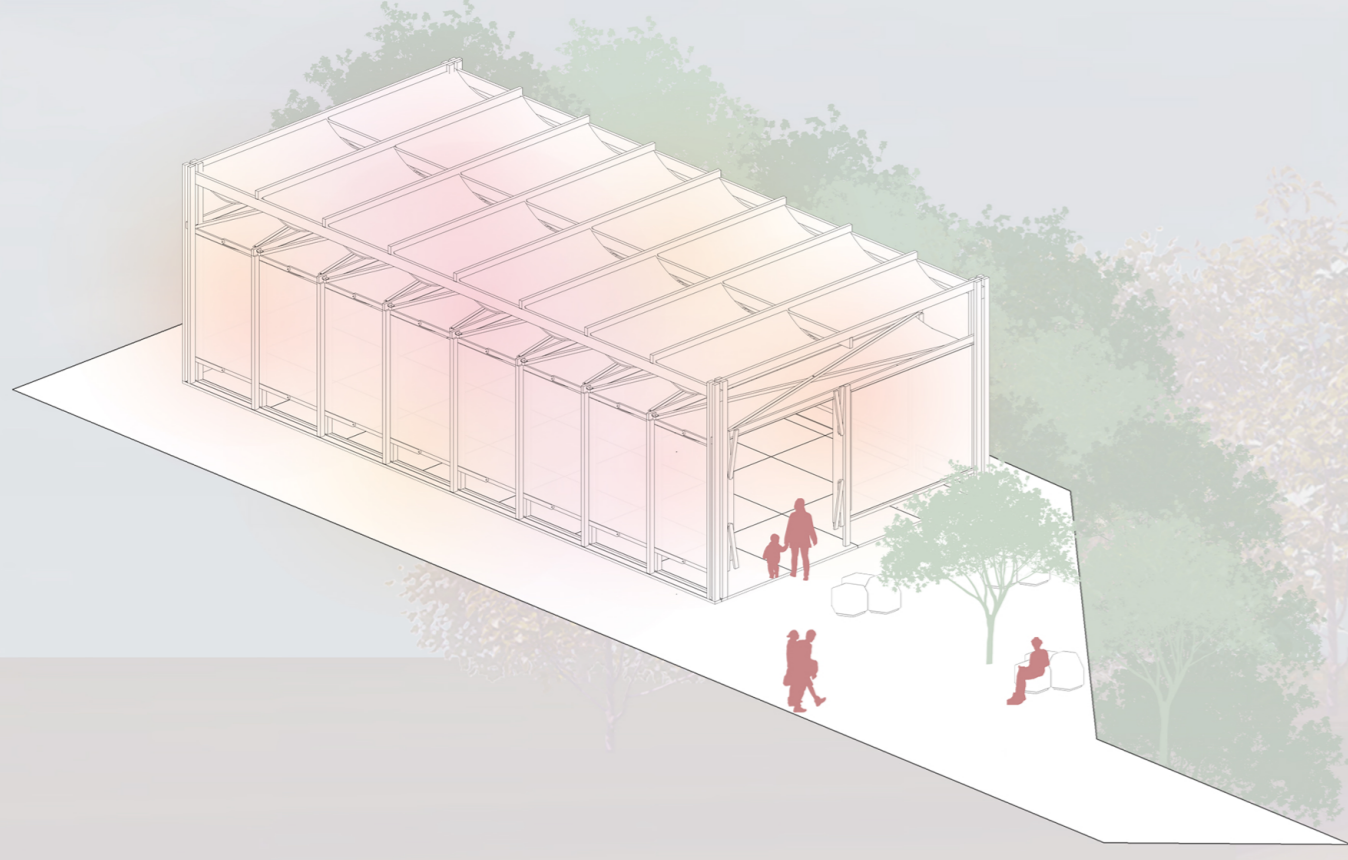

Totally closed : Place for Exhibitions and Parties. Its surface gives space for projections as a part of the exhibition/Party

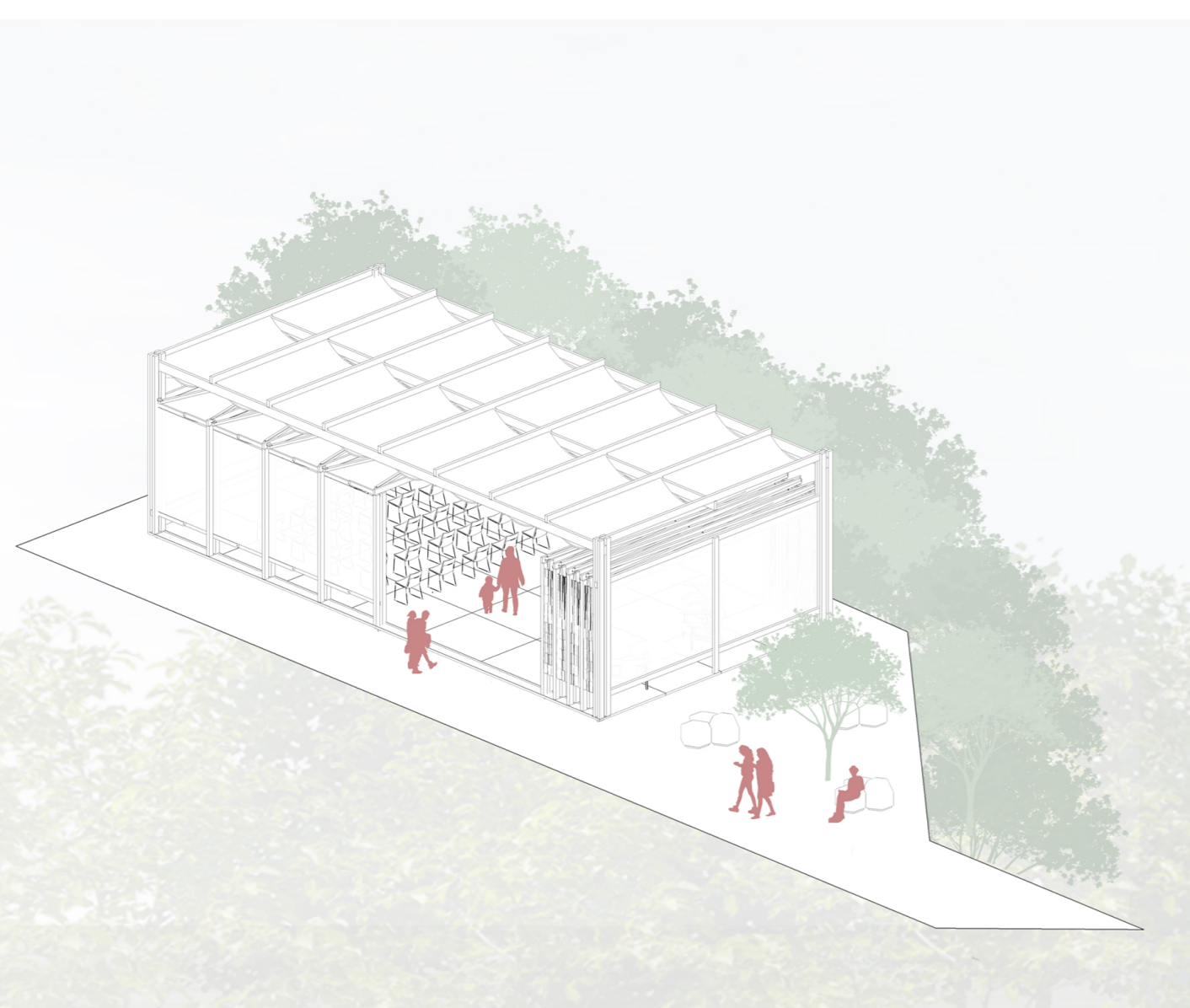

Half closed /Half open : Place for Lectures, Street Cinema and Exhibitions

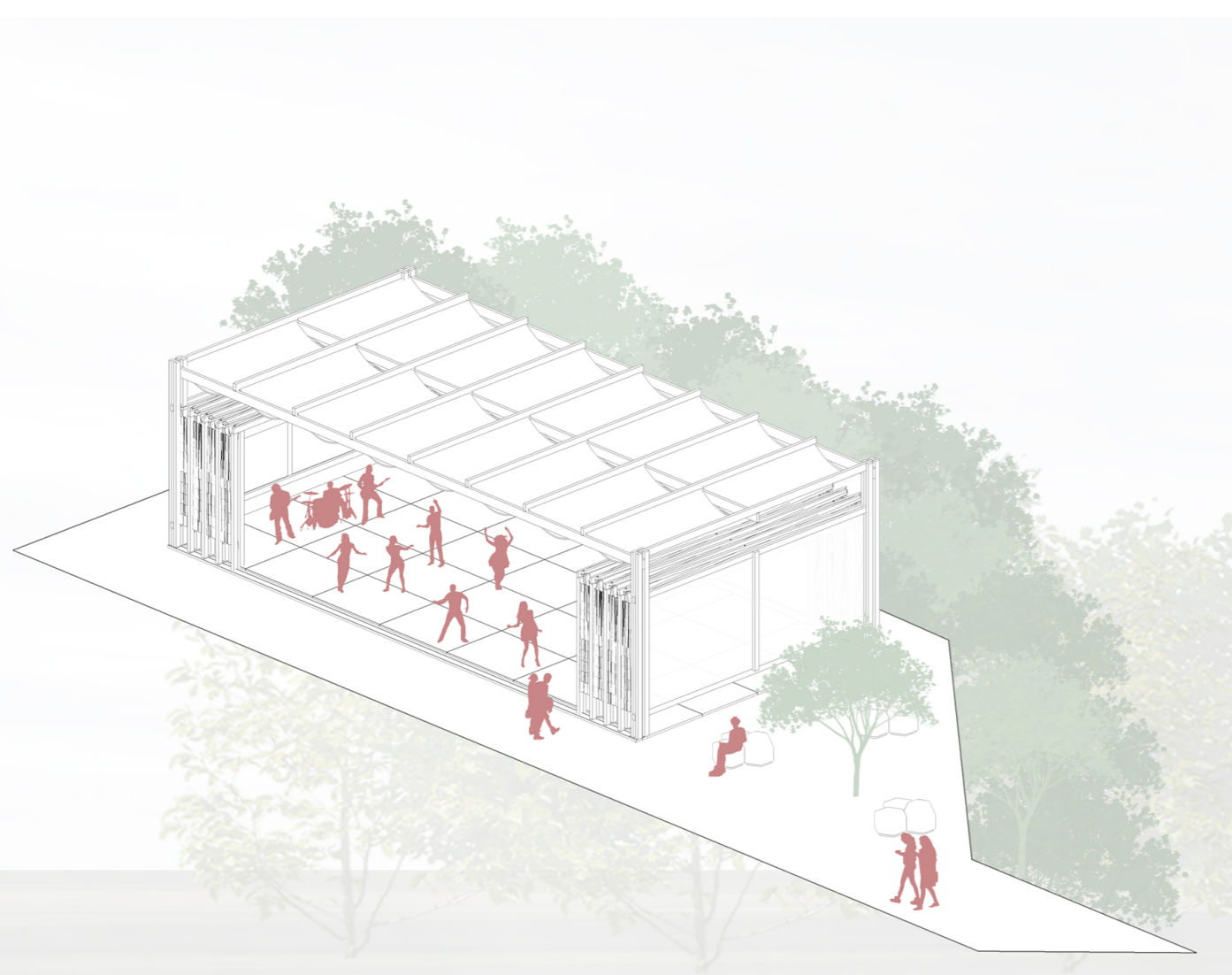

Totally open : Place for Sport's Classes, Yoga, Markets or Parties

